

2024 IN REVIEW

Student Involvement:



Faculty Involvement:



Projects Completed:

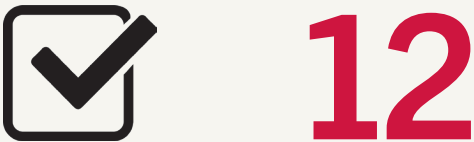

ROI: \$780,553

THE BASICS

The Youth Development Work Group's collaborations with community partners connected families with The Basics, a no-cost resource providing simple science-based tips and activities that support children's development from birth through age five. The group also provided 1,200 activity sheets to local restaurants to help children engage with The Basics principles.

"The UGA Archway Partnership just opened so many doors for us, for university resources to come in and enhance what we do as a community."

- Chip Blalock
Sunbelt Ag Expo
Executive Director



Celebrating 20 years of serving Georgia

PROJECT SPOTLIGHTS

PRIORITY AREAS

1. Community Collaboration & Communication
2. Community Development
3. Health and Wellness
4. Youth Development

“Most of the people in Georgia have never been to Athens. They know about the University of Georgia because they see it in their communities.”

*- Jere Morehead
President of the
University of Georgia*

MENTAL HEALTH CO-RESPONDER MODEL

A UGA Institute of Government study found that the co-responder model in Moultrie has saved the community an estimated \$644,000 over the first two years. These savings include reduction in jail usage and a reduction in mental health related emergency room visits.

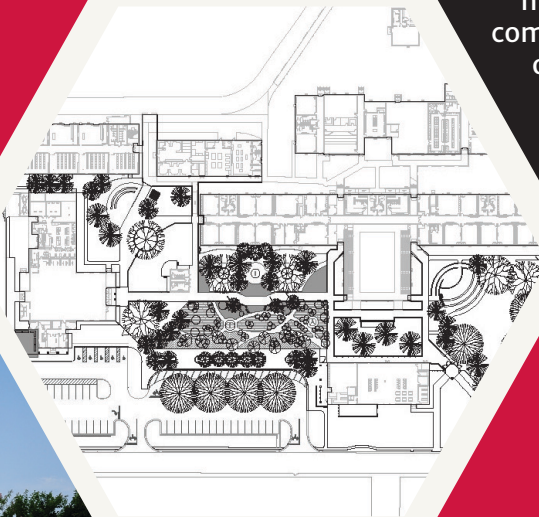

C.A. GRAY BEAUTIFICATION

Graduate students from the College of Environment+Design created outdoor space concepts for C.A. Gray Junior High School. The designs incorporated feedback from more than 500 students, faculty and staff. Ideas included outdoor classroom space, a teaching garden and enhanced traffic flow.

For more information on Archway Partnership in Colquitt County, contact our Archway Professional.

SARA HAND

350 Veterans Pkwy N
Building 1, Rm 132
Moultrie, GA 31788

229-702-6016
sara.hand@uga.edu

